

RECOMMENDED P.C.B. LAYOUT

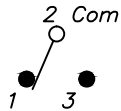

CIRCUIT: SPDT  
CONTACT CONFIGURATION

SWITCH FUNCTION		
PDS. 1	PDS. 2	PDS. 3
DN	NONE	<DN>
2-3	NONE	2-1

( ) = Momentary

NOTES:

- ALL DIMENSIONS IN MM
- GENERAL TOLERANCE: X.X=±0.4  
X.XX=±0.25
- TERM. NOS. FOR REF. ONLY
- CONTACT RATING: 3A @ 120 VAC or 28 VDC, 1A @ 250 VAC
- CONTACTS: SILVER
- ELECTRIC LIFE: 30,000 make-and-break cycles at full load.
- INSULATION RESISTANCE: 1,000 M ohm min.
- DIELECTRIC STRENGTH: 1,000 V RMS @sea level.
- OPERATING TEMP.: -30°C to 85°C

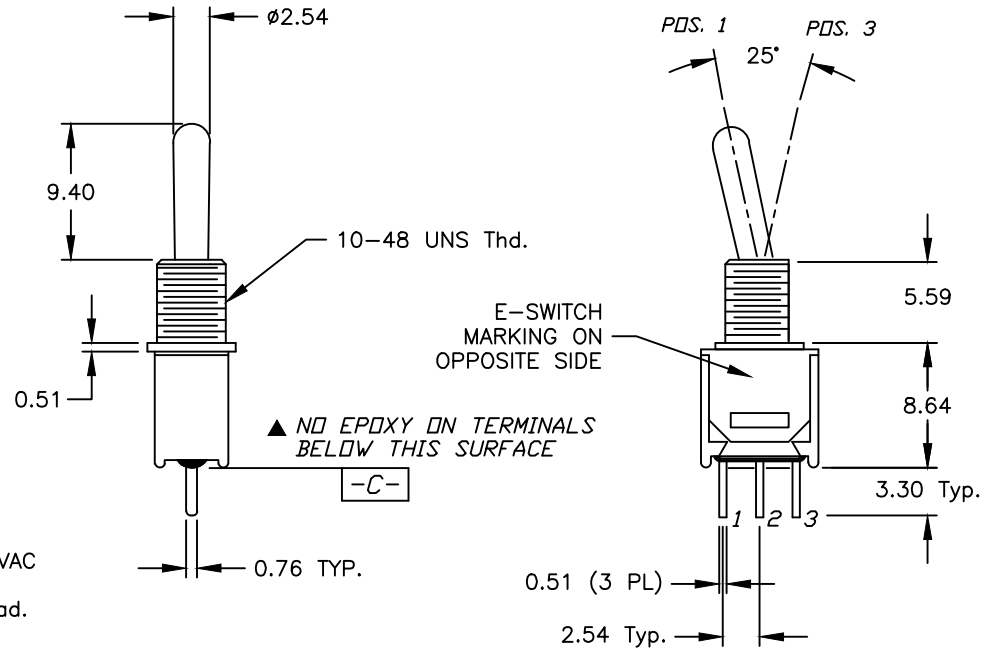
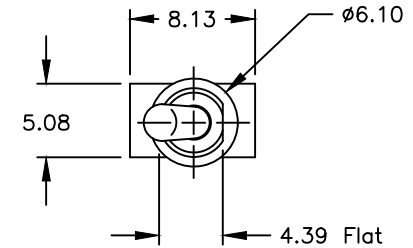

B	21942	UPDATE PRINT	8/4/15	MW
A	--	RELEASED FOR PRODUCTION	--	--
REV.	ECN No.	DESCRIPTION	DATE	CHKD

TITLE 200MSP2T1B1M2QE				
SCALE 2:1	DATE 9/18/98	DR MM	DWG T213005	REV B

THE INFORMATION CONTAINED IN THIS DOCUMENT IS PROPRIETARY TO E-SWITCH AND IS NOT TO BE COPIED OR TRANSFERRED